

The Thomson Collection of Ship Models

This audio tour is available to download at www.ago.net/podcasts



Art Gallery of Ontario
Musée des beaux-arts de l'Ontario

- 1 British Two-decker 70 Gun Warship, "Edinburgh", 1721
- 2 British Turret Deck Steamer, "Clan Alpine", 1899
- 3 Troop Landing Craft, around 1755-1760
- 4 Russian Icebreaker, design for two vessels: "Kosmá Mínin" and "Kniáz Pojársky", 1916
- 5 Japanese Liner, "Chichibu Maru" (renamed "Titibu Maru" in 1938, "Kamkura Maru" in 1939), around 1930
- 6 British Armoured Steam Cruiser, "H.M.S. Hogue", 1900
- 7 British Escort Aircraft Carrier, "HMS Activity", 1942
- 8 British Two-decker 50-54 Gun Warship, around 1703
- 9 British Two-decker 50 Gun Warship, "Bristol", 1774
- 10 British Revenue Lugger, "Alarm", around 1782
- 11 French Warship, "L'Ocean", 1810-1820
- 12 Double Watch Stand with British or French Two-decker 74 Gun Warship, 1795-1815
- 13 British Self-Righting Pulling and Sailing Lifeboat, around 1890,
British Self-Righting Pulling and Sailing Lifeboat, "Christopher Brown", 1868
- 14 British Armed Motor Launch, "Mimi", 1915
- 15 British State Barge (vessel built around 1700),
British Royal Yacht, "Caroline" (vessel built 1670),
British 18 Gun Schooner Yacht, "Transport Royal" (vessel built 1695)
- 16 British or French Three-decker 100 Gun Warship with
Admiral's Barge alongside, 1795-1815

The Thomson Collection of Ship Models

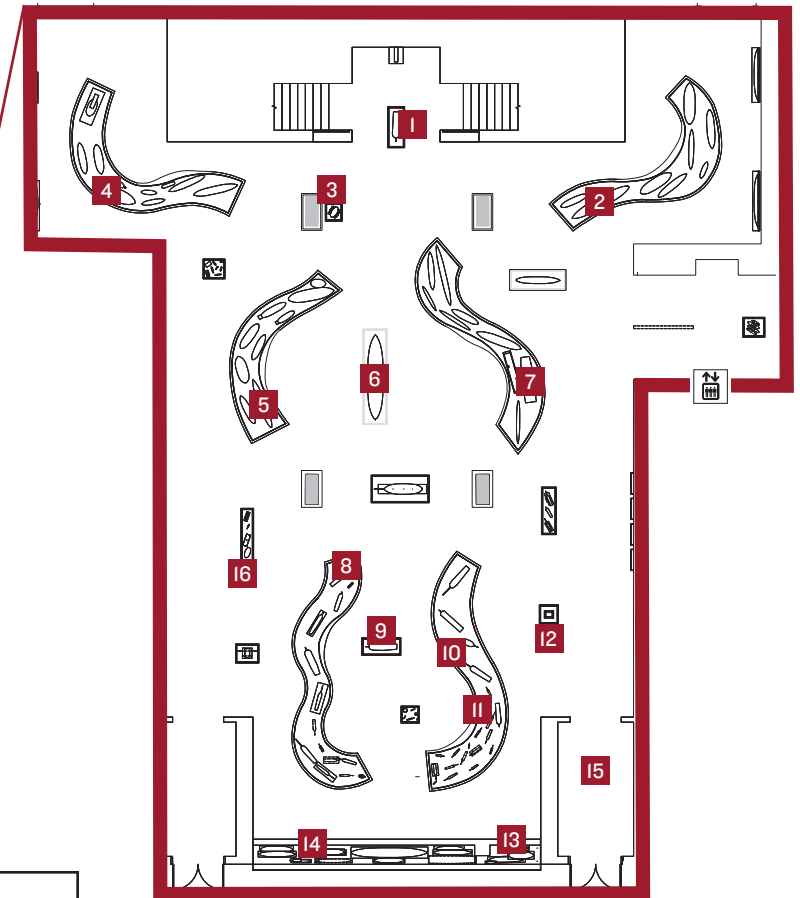

Concourse level

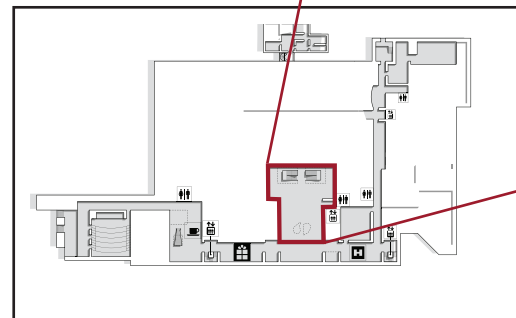

Legend

- | | |
|----------|------------|
| Café | Restaurant |
| Elevator | Shop |
| Hub | Washrooms |